

Maße in mm  
Dimensions in mm  
Cotes en mm  
Dimensioni in mm  
Dimensiones en mm

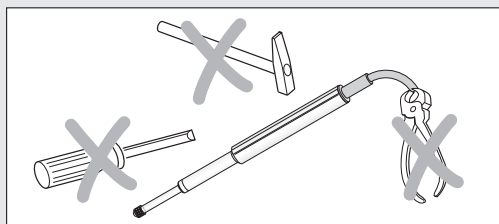
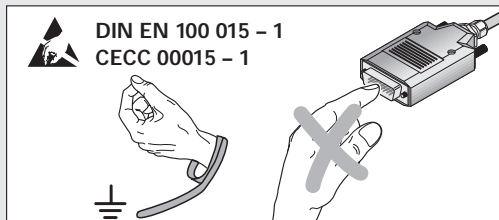
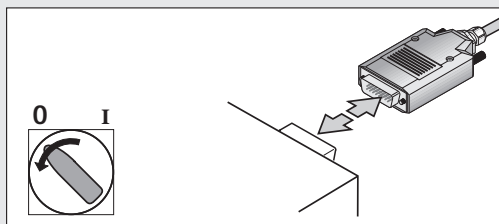
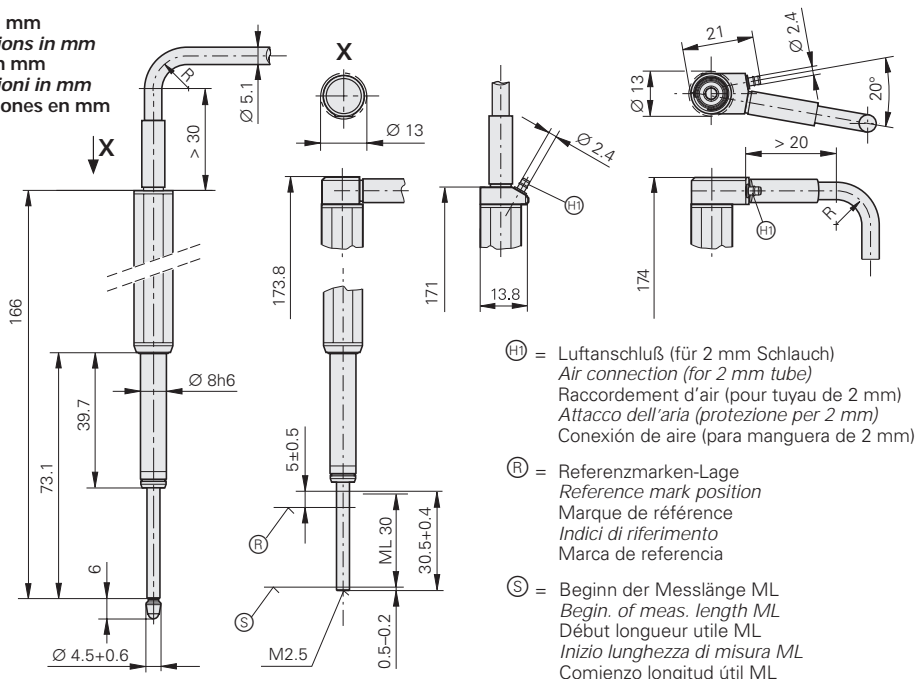

# HEIDENHAIN

Montageanleitung  
Mounting Instructions  
Instructions de montage  
Istruzioni di montaggio  
Instrucciones de montaje

## ST 3077 ST 3078

5/2004

$\text{Ø } 5.1 \text{ mm}$	$R_1 \geq 10 \text{ mm}$	$R_2 \geq 50 \text{ mm}$
	$R_1 \geq 40 \text{ mm}$	$R_2 \geq 100 \text{ mm}$

Zu starke Kraft klemmt Meßbolzen  
Excessive force jams the plunger  
Force trop élevée serre la tige de mesure  
Una forza eccessiva blocca lo stelo di misura  
Una fuerza excesiva bloquea el vástago de medición

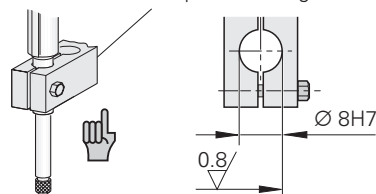

ST 3077

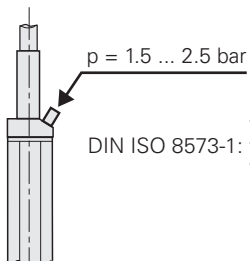

tab 2/class 1  
DIN ISO 8573-1: tab 3/class 4  
tab 4/class 1

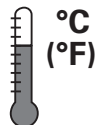

°C  
(°F)

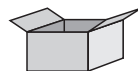

-30 ... 80 °C  
(-22 ... 176 °F)

DR. JOHANNES HEIDENHAIN GmbH

Dr.-Johannes-Heidenhain-Straße 5  
83301 Traunreut, Germany

☎ +49 (8669) 31-0

☎ +49 (8669) 50 61

e-mail: info@heidenhain.de

Technical support ☎ +49 (8669) 31-10 00

Measuring systems ☎ +49 (8669) 31-31 04

e-mail: service.ms-support@heidenhain.de

TNC support ☎ +49 (8669) 31-31 01

e-mail: service.nc-support@heidenhain.de

NC programming ☎ +49 (8669) 31-31 03

e-mail: service.nc-pgm@heidenhain.de

PLC programming ☎ +49 (8669) 31-31 02

e-mail: service.plc@heidenhain.de

Lathe controls ☎ +49 (7 11) 9528 03-0

e-mail: service.hsf@heidenhain.de

www.heidenhain.de

Ve 00

516 398-91 · 6 · 6/2005 · E · Printed in Germany · Änderungen vorbehalten

Subject to change without notice · Sous réserve de modifications · Con riserva di modifiche · Sujeto a modificaciones



ST 3077  
ST 3078

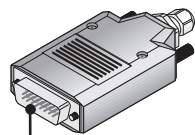
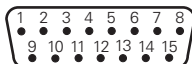

Elektronik im Stecker  
Electronics in connector  
Electronique intégrée dans la prise  
Elettronica nel connettore  
Electrónica en el conector

1	9	3	11	14	7	4	2	Schirm Shield blindage schermo blindaje	12	10	13
$U_{a1}$	$\overline{U}_{a1}$	$U_{a2}$	$\overline{U}_{a2}$	$U_{a0}$	$\overline{U}_{a0}$	5V $U_P$	0V $U_N$		5V sensor	0V sensor	$\overline{U}_{aS}$

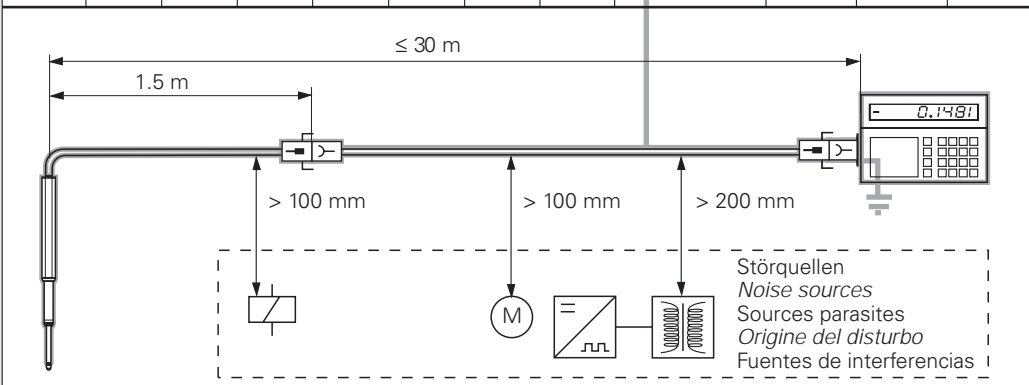

Meßeinsatz wechseln  
Changing the measuring contact  
Changer de touche de mesure  
Cambiare dispositivo di misura  
Cambiar punta de medida

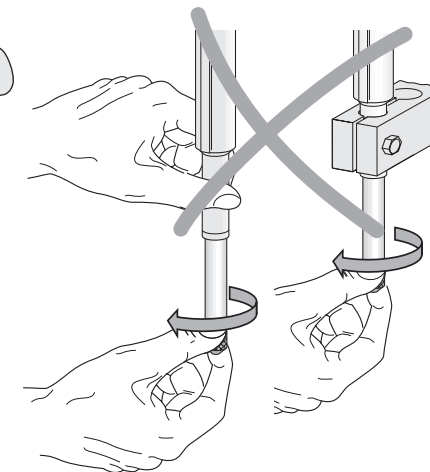
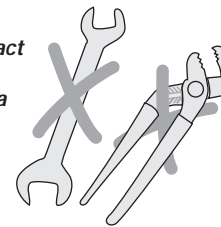

1.



Kein Drehmoment in diesem Bereich anwenden  
Use no torque in this area  
Ne pas appliquer de couple dans cette zone  
Non smontare in questo modo  
No ejercer ningún momento de giro en esta zona

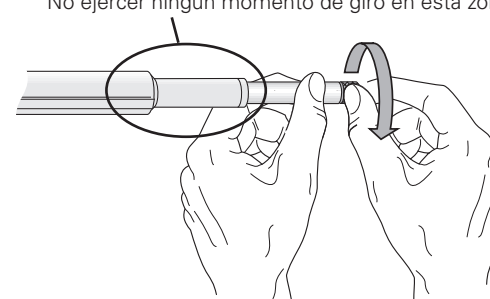

2.

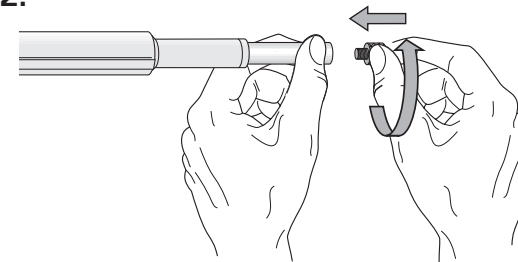

$U_P = 5V \pm 10\%$   
(70 ± 20 mA)

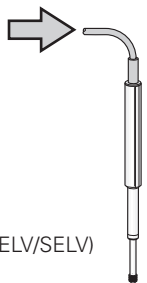

$\overline{U}_{aS}$ : Störungssignal  
Fault detection signal  
Signal de perturbation  
Segnale di malfunzionamento  
Señal de avería

$\overline{U}_{aS}$  = High: ✓

$\overline{U}_{aS}$  = Low: !



EN 50 178/4.98; 5.2.9.5  
IEC 364-4-41: 1992; 411(PELV/SELV)  
(siehe, see, voir, vedi, véase  
HEIDENHAIN D 231 929)

TTL

$U_{a1}, U_{a2}, U_{a0}$   
 $\overline{U}_{a1}, \overline{U}_{a2}, \overline{U}_{a0}, \overline{U}_{aS}$

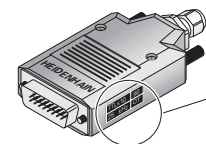
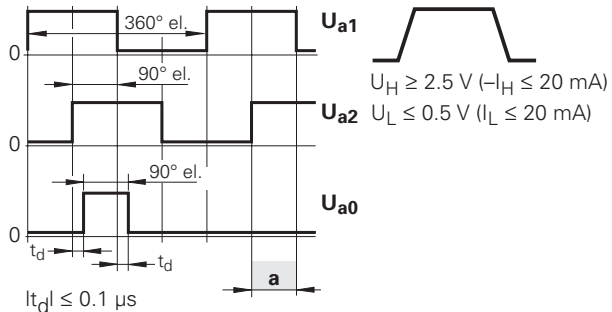

TTLx10 XX  
100 kHz XX

\* mech. Begrenzt  
Mech. limited  
Limité mécaniquement  
Meccanicamente limitato  
Meccanicamente limitato

	TTLx5		TTLx10		
	50 kHz	100 kHz	25 kHz	50 kHz	100 kHz
<b>v</b> = max.	60 m/min	72 m/min*	30 m/min	60 m/min	72 m/min*
<b>a</b> =	≥ 1 μs	≥ 0.5 μs	≥ 1 μs	≥ 0.5 μs	≥ 0.25 μs

